



TAKING YOUR
LIFESTYLE
TO **NEW HEIGHTS.**



G^AURS
RUNWAY
— SUITES —
Commercial Studio Apartments



G^AUR
YAMUNA
CITY

A 101 HECTARES (250 ACRES)
INTEGRATED TOWNSHIP
ON YAMUNA EXPRESSWAY

NEAR UPCOMING NOIDA
INTERNATIONAL AIRPORT



THE WORLD
HAS CHECKED-IN
AT NOIDA.



**NOIDA
INTERNATIONAL AIRPORT**
India's Largest Airport being built with an investment of
Rs. 29,500 CRORES
approx by Zurich Airport International AG



FILM CITY
India's Largest Film City
project developing over an area of
1000 acres

VIVO,
a leading mobile manufacturer has taken
169 acres of land and will invest
Rs. 3500 CRORES
creating
25,000 JOBS

India's Biggest
**SMARTPHONE
MANUFACTURING
HUB.**

India's Fourth Largest
**IT-BPO
DESTINATION.**

THE THRUST BEHIND NOIDA'S BOOST.



YEIDA stands for Yamuna Expressway Industrial Development Authority and today has the largest industrial landbank in the country which would see rapid development. The initial budget set for YEIDA was Rs. 12,500 crore approximately. With an area of 2,689 sq km under its belt, it is the biggest industrial township project that covers connectivity, industrial development, and infrastructure development.

YEIDA also promises to develop smart villages along the 165 km stretch. It is one of the driving forces behind Noida's growth and development.

YEIDA's master plan of 2031 predicts rapid and extensive real estate development.

Yamuna Expressway is the **MOST MODERN INFRASTRUCTURE** development that connects Delhi/Noida/Gr. Noida with Western UP/Agra and Lucknow.

It's a 165 km long 6-lane Expressway surrounded by **1,187 VILLAGES** comprising Of **6 DISTRICTS**

The traveling time between **AGRA & DELHI** that stretches 211 km has come down to approx. 150 minutes & just 90 minutes from Greater Noida.

The U.P. government has declared Yamuna Expressway belt as an **ELECTRONICS MANUFACTURING ZONE**

The U.P. government has appointed Yamuna Expressway as the nodal agency of the project and YEIDA has already identified **5,000 HECTARES** for this purpose.

NOIDA IS CRUISING WITH EASE & ACCESSIBILITY.

AIRPORT'S EFFECT ON THE REGION. (1)

- Jewar will likely to serve as major logistics and travel hub for various manufacturing and export centers as soon as the airport becomes operational.
- Like other major infrastructure projects that benefit real estate markets, the Noida International Airport, too, will change the property market dynamics in Noida and the adjoining areas making Noida International Airport the biggest job creator.

EASTERN PERIPHERAL EXPRESSWAY: (2)

- a 135 km long, six-lane expressway intersects and passes through Yamuna Expressway.
- Eastern Peripheral Expressway is expected to divert more than 50,000 trucks away from Delhi and reduce air pollution in Delhi by 27%.
- It was inaugurated on 27 May 2018 by Prime Minister Narendra Modi.
- EPE to be connected with the airport.

THE METRO LINK: (3)

- A direct metro line to connect Jewar Airport with Delhi's Indira Gandhi International Airport.
- Greater Noida metro line will also intersect the proposed line.

THE RAPID RAIL LINK: (4)

- Rapid Rail Transit System (RRTS) will connect Sarai Kale Khan Bus transit and the airport.



1) <https://www.hindustantimes.com/noida/noida-builders-entrepreneurs-upbeat-about-jewar-airport-nod/story-CDhKCx54fOYN50Y2euqmTN.html> - Hindustan Times - 23 Apr 2018

2) EPE Inauguration News: <https://www.indiatoday.in/education-today/gk-current-affairs/story/eastern-peripheral-expressway-inaugurated-by-pm-modi-is-likely-to-decrease-delhi-pollution-by-27-per-cent-1243728>
India Today - 28.05.2018

3) Metro connectivity between IGI and Jewar- <https://indianexpress.com/article/cities/delhi/yamuna-authority-plan-elevated-road-rapid-rail-options-to-link-new-jewar-airport-5230849/>
Indian Express 19.03.2019

4) <https://timesofindia.indiatimes.com/city/delhi/jewar-airport-to-have-2-train-links-with-delhi/articleshow/63888923.cms>
Times of India 24.04.2018

WHY YAMUNA EXPRESSWAY

The Yamuna Expressway is a dream location for potential home buyers. It is one of the longest controlled-access expressways in India and directly connects Greater Noida to Agra which has enhanced the realty prospects of neighbouring regions as well. Ever since the Noida International Airport has been given the green light; it has experienced a major boom in value. It is giving way to progress, employment and supreme convenience. Eastern Peripheral Expressway that passes through Yamuna Expressway will benefit those travelling from Noida, Greater Noida and Gaur Yamuna City.

Yamuna Expressway is well connected to various amenities in the vicinity like hotels, schools, hospitals etc. Future developments on Yamuna Expressway include metro line expansion, construction of IT Hub, proposed monorail and ISBT etc. F1 Track at Buddh International Circuit is yet another attractive feature of Yamuna Expressway. The UP Government has declared Yamuna Expressway as an electronics manufacturing hub as well. To sum it all up, the Yamuna Expressway is where everything of essence is coming together to create the perfect framework for a harmonious life.



Hindustan Times 22nd October 2020



Hindustan Times 8th October 2020

YAMUNA DWAR - ENTRANCE TO
GAUR YAMUNA CITY



**GAUR
YAMUNA
CITY**

**A 101 HECTARES (250 ACRES)
INTEGRATED TOWNSHIP
ON YAMUNA EXPRESSWAY**

DESTINATION NEXT

Gaur Yamuna City (GYC) is an integrated township sprawled over a massive 101 hectares (250 acres). It is situated on the Yamuna Expressway, which is a 6 lane (extendable to 8 lanes), 165 km. long access-controlled highway connecting GYC to Noida, Greater Noida and Delhi. A well-planned highway with flyovers and interjections enabling clutter-free traffic. Proposed metro will further enhance its connectivity to the DMRC network.

Gaur Yamuna City offers Plots, Apartments, Retail Shops, Studio Apartments, Themed Villas, Sports and a lot more.

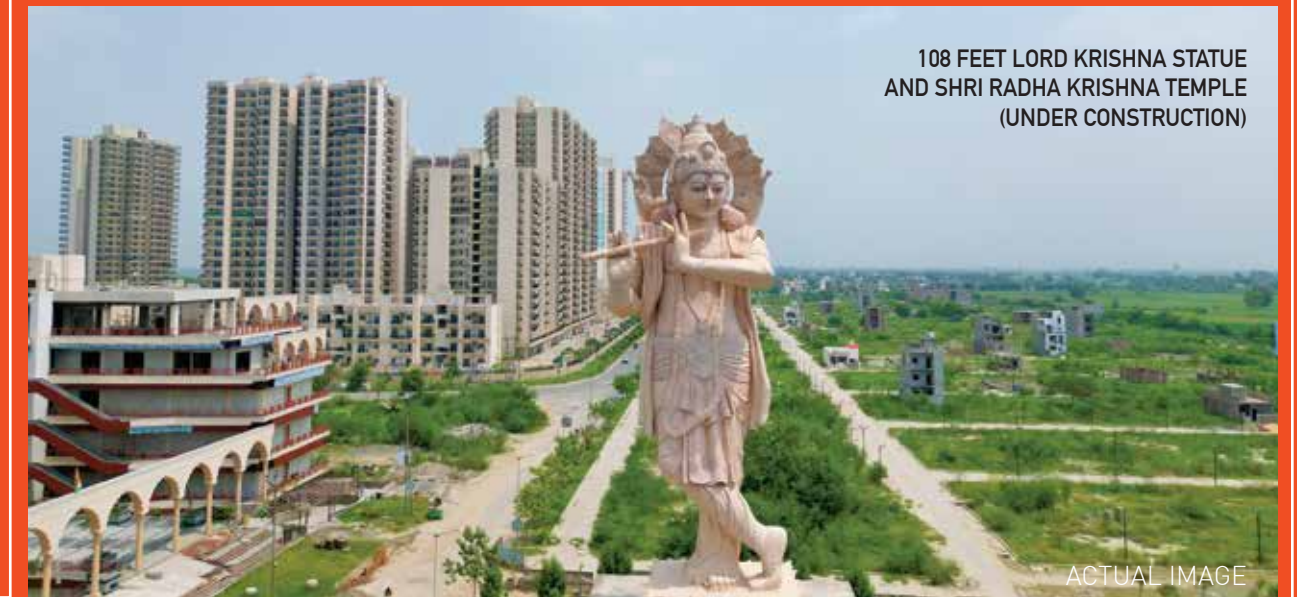

108 FEET LORD KRISHNA STATUE
AND SHRI RADHA KRISHNA TEMPLE
(UNDER CONSTRUCTION)

ACTUAL IMAGE



ACTUAL IMAGE



ROAD INFRASTRUCTURE



ARTIST'S IMPRESSION

HIGHLIGHTS

- ✦ AN INTEGRATED TOWNSHIP OF 101 HECTARE (250 ACRES) JUST 8-10 KMS*. FROM UPCOMING NOIDA INTERNATIONAL AIRPORT.
- ✦ BEAUTIFUL YAMUNA LAKE PARK WITH BOATING FACILITY.
- ✦ THOUSANDS OF FAMILIES HAVE TAKEN POSSESSION AND RESIDING WITHIN THE TOWNSHIP.
- ✦ OPERATIONAL GYC GALLERIA CONVENIENT SHOPPING CENTER.
- ✦ INDIA'S TALLEST STATUE OF LORD KRISHNA STANDING AT 108 FEET TALL ATOP A TEMPLE (UNDER CONSTRUCTION).
- ✦ OPERATIONAL GAURS INTERNATIONAL SCHOOL.
- ✦ MORE THAN 4 KM. ROAD INFRASTRUCTURE IN PLACE.
- ✦ RAIN WATER HARVESTING, SEWAGE TREATMENT PLANT AND SOLID WASTE MANAGEMENT SYSTEM.
- ✦ DEVELOPING SPECTACULAR CRICKET GROUND, TENNIS, BADMINTON, VOLLEYBALL, BASKETBALL, SKATING RINK, ATHLETIC TRACK & MORE WITHIN THE TOWNSHIP.

EARMARKED FACILITY PLOTS

(AS PER MASTER PLAN)

- ✦ PETROL PUMP
- ✦ CULTURAL CITY CENTRE
- ✦ MILK BOOTH & CONVENIENT SHOPS
- ✦ NURSING HOMES / DISPENSARY
- ✦ CRECHE & PLAY SCHOOL
- ✦ COMMERCIAL BUILDINGS

YAMUNA LAKE PARK



16TH PARKVIEW



GYC GALLERIA (SHOPPING COMPLEX)



ACTUAL IMAGES

— INTRODUCING —

G^AURS RUNWAY — SUITES — Commercial Studio Apartments

@



A 101 HECTARES (250 ACRES)
INTEGRATED TOWNSHIP
ON YAMUNA EXPRESSWAY



THE HIGHEST ALTITUDE OF
CONTEMPORARY LIVING.

WELCOME ON BOARD.
WE ARE ENROUTE TO
MODERN LIVING.



ARTIST'S IMPRESSION

Disclaimer: All images including stock images, colours, pictures and accessories are indicative and used for illustrative purposes only. For the actual project details, please refer to the specifications mentioned in the subsequent pages of this brochure.

**G^AURS
RUNWAY**
— SUITES —
Commercial Studio Apartments

@

**G^AUR
YAMUNA
CITY**
A 101 HECTARES (250 ACRES)
INTEGRATED TOWNSHIP
ON YAMUNA EXPRESSWAY

ULTIMATE LOUNGE FOR LEISURE

Gaurs Runway Suites is an ultra-modern concept for an unmatched experience of contemporary living. Modishly built, it has commercial spaces up to the third floor followed by multi - level car parking and the rest of the tower has commercial studio apartments. It offers 1 BHK commercial studio apartments of 42.73 sq. mtr. (460 sq. ft.). It is a pinnacle of engineering excellence and conceptualising brilliance making it every modern city dweller's dream.

It forms part of the most coveted Gaur Yamuna City, an integrated township that has world - class amenities for an exclusive lifestyle. GYC is spread across a massive 101 Hectares (250 acres) and advantageously situated on the 6 lane Yamuna Expressway making it easily accessible and affluently convenient. Gaurs Runway Suites, having all the advantages of its location and the unique amalgamation of commercial and retail is one of the most favourable destinations for home buyers and investment opportunities.

**G^AURS
RUNWAY**
— SUITES —
Commercial Studio Apartments

**COMMERCIAL
SHOPS**

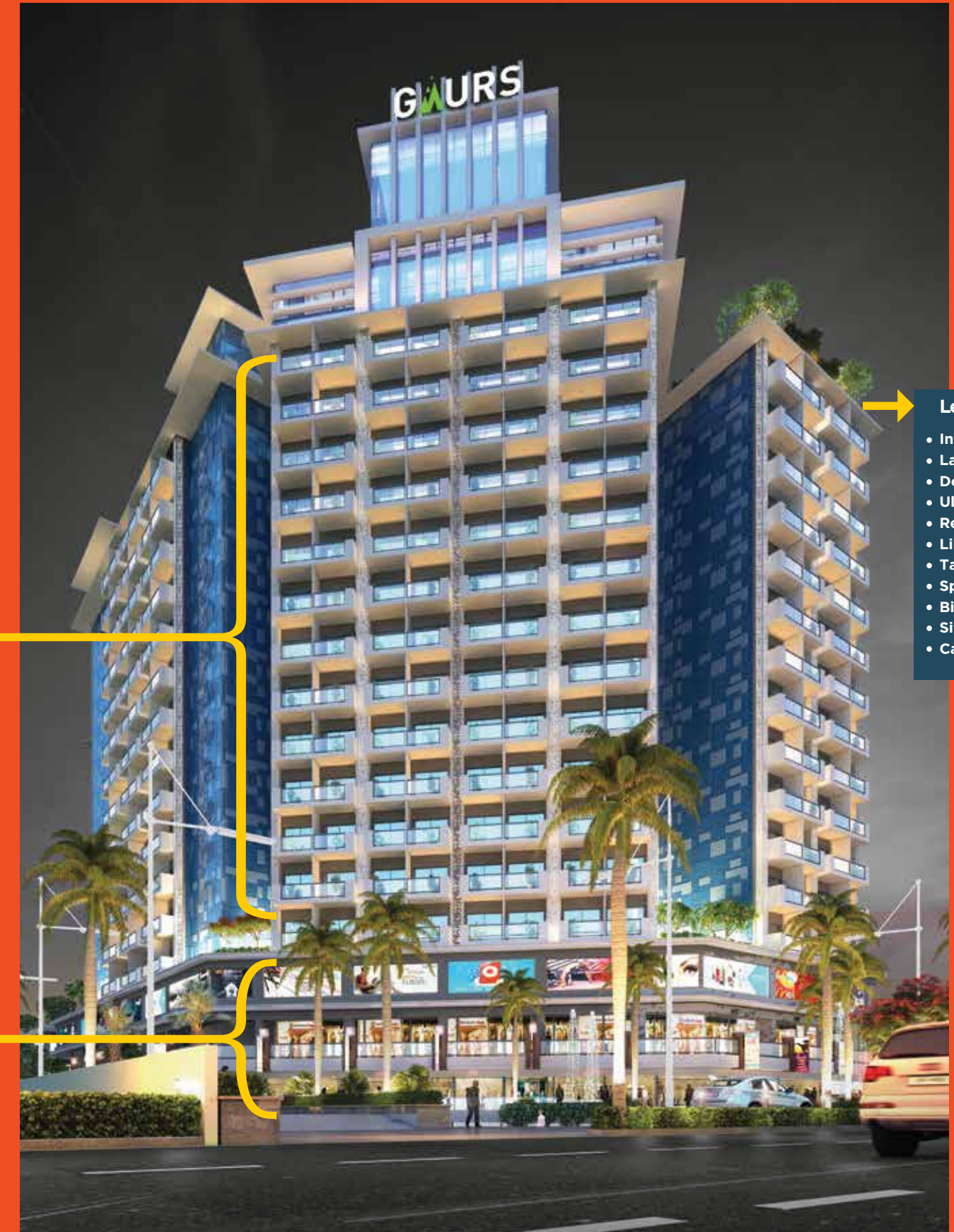

Level 13th Terrace

- Infinity Pool
- Landscape Party Terrace
- Double Height Party Hall
- Ultra Modern Gymnasium
- Restaurant
- Library
- Table Tennis
- Spa
- Billiards Room
- Sitting Room
- Card Room

Disclaimer:

All images including stock images, colours, pictures and accessories are indicative and used for illustrative purposes only. For the actual project details, please refer to the specifications mentioned in the subsequent pages of this brochure.



**GAURS
RUNWAY**
— SUITES —
Commercial Studio Apartments

**THE PLUSH FACE OF
CONTEMPORARY LIVING
TO TAKE YOU ON A
MEMORABLE JOURNEY.**



ARTIST'S IMPRESSION

Disclaimer: All specifications, images including stock images, colours, pictures and accessories are indicative and used for illustrative purposes only. For the actual project details, please refer to the specifications mentioned in the subsequent pages of the brochure.

Disclaimer: All specifications, images including stock images, colours, pictures and accessories are indicative and used for illustrative purposes only. For the actual project details, please refer to the specifications mentioned in the subsequent pages of the brochure.

WHEN IMMACULATE DESIGNS ARE MET WITH FINE CRAFTSMANSHIP, YOU ARE IN FOR A MEMORABLE EXPERIENCE.

Actual Images of Sample Apartments.
Meticulously designed to match the modish you.



Actual Images of Sample Apartments.



Contemporary designed to unwind the urban you.

Protean designed to comfort the ultra-modern you.



AMENITIES



INFINITY POOL

For those who live on the edge, we present to you our magnificent infinity pool that goes beyond the convention.



GYM

Build up your lifestyle in every sphere.

PARTY HALL

Limitless fun comes to life every day.





LEGEND

- ## A. MASTER PLAN COMMERCIAL

- ## B. SCHOOL / INSTITUTIONAL - EDUCATIONAL PLOTS

- ### C. CONVENIENT / SECTOR SHOPPING

- #### D. DISPENSARY - NURSING HOME (NH)

- ## E. GYC GALLERY

- GR-01. ECO PARK**
- LAKE YAMUNA
 - CHILDREN PARK
 - PICNIC SPOT
 - BOATING FACILITIES
 - FOOD COURT
 - LAKE PROMENADE & BIRD WATCHING

- GR-02. RECREATIONAL GREEN AREA
(SPORTS PARK)**
- OPEN AIR THEATER
 - CHILDREN PLAY AREA
 - CRICKET GROUND
 - OTHER SPORTS FACILITIES

- FACILITIES**
- RELIGIOUS PLOT
 - MILK BOOTH
 - CLUB FACILITIES

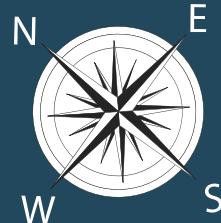

Commercial Studio Apartments



2ND PARKVIEW
PLOTS & VILLAS

YAMUNA LAKE PARK



GAUR WATERFRONT PLOTS
1ST B PARKVIEW | GAUR YAMUNA CITY



GYC GALLERY
CONVENIENT SHOPPING CENTER



16TH PARKVIEW
2/3/4 BHK APARTMENTS
& INDEPENDENT FLOOR

60 M WIDE SECTOR ROAD

YAMUNA EXPRESSWAY

TO NOIDA

TO AGRA

32ND PARKVIEW
PLOTS & VILLAS

**GYC
SPORTS
PARK**

7TH PARKVIEW
Luxury By Nature

GURS
INTERNATIONAL
SCHOOL
तमसो मा ज्योतिर्गमय।



**BHAGWAN SHRI KRISHNA
MURTI & SHRI
RADHA KRISHNA MANDIR**

Gaurs Realtech Pvt. Ltd. Sub Lease Deed of:
Part 1 Vide Book No-1, Vol No-13251, Page No-299 to 450, Registration / Document No-11798, Sub Registrar Sadar, Gautambudh Nagar, (UP) on 22-05-2013, Part 2 Vide Book No-1, Vol No-14222, Page No-85 to 134, Registration / Document No-24479, Sub Registrar Sadar, Gautambudh Nagar, (UP) on 05-10-2013, Part 3 Vide Book No-1, Vol No-14828, Page No-227 to 282, Registration / Document No-781, Sub Registrar Sadar, Gautambudh Nagar, (UP) on 09-01-2014, Part 4 Vide Book No-1 6236, Page No-189 to 242, Registration / Document No-20325, Sub Registrar Sadar, Gautambudh Nagar, (UP) on 27-06-2014, Part 5 Vide Book No-1 Vol No- 16526, Page No-107 to 162, Registration / Document No-25183, Sub Registrar Sadar, Gautambudh Nagar, (UP) on 31-07-2014, Project Approval No-16th Parkview, PLG/(BP)-29/4072/2017/27 Dated 15-11-2017, 2nd & 32nd Parkview: YEA/PLG/(BP)-62/19003/2016 Dated 31-03-2017, 3rd & 6th Parkview: YEA/PLG/(BP)-62/54470 Dated 10-04-2018, Gaurs Runway Suites: YEA/PLG/(BP)-96/79424 Dated 07-02-2019, Map Sanctioned of Gaurs Yamuna City Townships Project, vide letter Ref. No. YEA/PLANNING/BO-62/19003/2016 Dated: 31/03/2017 by Yamuna Expressway Industrial Development Authority.
All images, perspective, specifications, features, figures, are only indicative and not a legal offering. All project related sanctions any other statutory compliance can be seen in person at our office.
1 sq. mtr = 10.764 sq. ft. 1 acre=4047 sq. mtr. (approx.)

GROUND/3rd FLOOR PLAN (G01-G62)

DETAIL OF FLOORS				
AS PER BROCHURE*	AS PER SANCTION*	AS PER RERA **		
3RD FLOOR	3RD FLOOR	GROUND		
4TH TO 14TH FLOOR	4TH TO 14TH FLOOR	1ST TO 11TH FLOOR		
15TH FLOOR	15TH FLOOR	12TH FLOOR		
16TH FLOOR	16TH FLOOR	13TH FLOOR		



YAMUNA EXPRESSWAY



Gaurs Realtech Pvt. Ltd. Sub Lease Deed of:
Part 1 Vide Book No-1, Vol No-13251, Page No-299 to 450, Registration / Document No-11798, Sub Registrar Sadar, Gautambudh Nagar, (UP) on 22-05-2013, Part 2 Vide Book No-1, Vol No-14222, Page No-85 to 134, Registration / Document No-24479, Sub Registrar Sadar, Gautambudh Nagar, (UP) on 05-10-2013, Part 3 Vide Book No-1, Vol No-14828, Page No-227 to 282, Registration / Document No-781, Sub Registrar Sadar, Gautambudh Nagar, (UP) on 09-01-2014, Part 4 Vide Book No-1 6236, Page No-189 to 242, Registration / Document No-20325, Sub Registrar Sadar, Gautambudh Nagar, (UP) on 27-06-2014, Part 5 Vide Book No-1 Vol No- 16526, Page No-107 to 162, Registration / Document No-25183, Sub Registrar Sadar, Gautambudh Nagar, (UP) on 31-07-2014,
Project Approval No-16th Parkview, PLG/(BP)-29/4072/2017/27 Dated 15-11-2017, 2nd & 32nd Parkview: YEA/PLG/(BP)-62/19003/2016 Dated 31-03-2017, 3rd & 6th Parkview: YEA/PLG/(BP)-62/54470 Dated 10-04-2018, Gaurs Runway Suites: YEA/PLG/(BP)-96/79424 Dated 07-02-2019
Map Sanctioned of Gaurs Yamuna City Township Project vide letter Ref. No. YEA/PLANNING/BO-62/19003/2016 Dated: 31/03/2017 by Yamuna Expressway Industrial Development Authority.
All images, perspective, specifications, features, figures, are only indicative and not a legal offering. All project related sanctions any other statutory compliance can be seen in person at our office.
1 sq. mtr = 10.764 sq. ft. 1 acre=4047 sq. mtr. (approx.)

TYPICAL FLOOR PLAN (1st-11th/4th-14th FLOOR)

DETAIL OF FLOORS				
AS PER BROCHURE*	AS PER SANCTION*	AS PER RERA **		
3RD FLOOR	3RD FLOOR	GROUND		
4TH TO 14TH FLOOR	4TH TO 14TH FLOOR	1ST TO 11TH FLOOR		
15TH FLOOR	15TH FLOOR	12TH FLOOR		
16TH FLOOR	16TH FLOOR	13TH FLOOR		

YAMUNA EXPRESSWAY



Gaur's Realtech Pvt. Ltd. Sub Lease Deed of:
Part 1 Vide Book No-1, Vol No-13251, Page No-299 to 450, Registration / Document No-11798, Sub Registrar Sadar, Gautambudh Nagar, (UP) on 22-05-2013, Part 2 Vide Book No-1, Vol No-14222, Page No-85 to 134, Registration / Document No-24479, Sub Registrar Sadar, Gautambudh Nagar, (UP) on 05-10-2013, Part 3 Vide Book No-1, Vol No-14828, Page No-227 to 282, Registration / Document No-781, Sub Registrar Sadar, Gautambudh Nagar, (UP) on 09-01-2014, Part 4 Vide Book No-1 6236, Page No-189 to 242, Registration / Document No-20325, Sub Registrar Sadar, Gautambudh Nagar, (UP) on 27-06-2014, Part 5 Vide Book No-1 Vol No- 16526, Page No-107 to 162, Registration / Document No-25183, Sub Registrar Sadar, Gautambudh Nagar, (UP) on 31-07-2014, Project Approval No-16th Parkview, PLG/(BP)-29/4072/2017/27 Dated 15-11-2017, 2nd & 32nd Parkview: YEA/PLG/(BP)-62/19003/2016 Dated 31-03-2017, 3rd & 6th Parkview: YEA/PLG/(BP)-62/5470 Dated 10-04-2018, Gaur's Runway Suites: YEA/PLG/(BP)-96/79424 Dated 07-02-2019, Map Sanctioned of Gaur Yamuna City Township Project vide letter Ref. No. YEA/PLANNING/80-62/19003/2016 Dated: 31/03/2017 by Yamuna Expressway Industrial Development Authority.
All images, perspective, specifications, features, figures, are only indicative and not a legal offering. All project related sanctions any other statutory compliance can be seen in person at our office.
1 sq. mtr = 10.764 sq. ft. 1 acre=4047 sq. mtr. (approx.)

12th/15th FLOOR PLAN (1201-1256)

DETAIL OF FLOORS				
AS PER BROCHURE*	AS PER SANCTION*	AS PER RERA **		
3RD FLOOR	3RD FLOOR	GROUND		
4TH TO 14TH FLOOR	4TH TO 14TH FLOOR	1ST TO 11TH FLOOR		
15TH FLOOR	15TH FLOOR	12TH FLOOR		
16TH FLOOR	16TH FLOOR	13TH FLOOR		



YAMUNA EXPRESSWAY

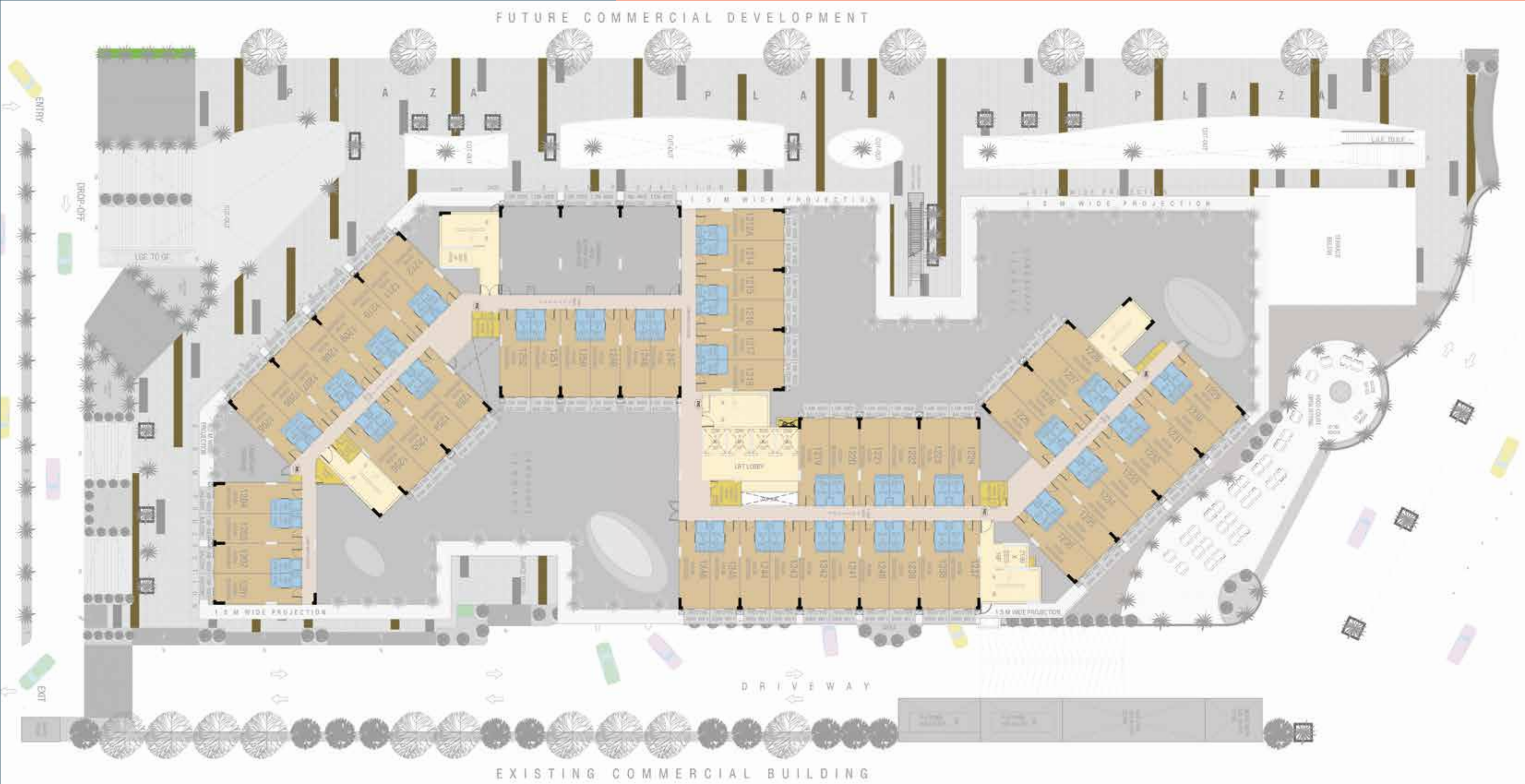

Gaurs Realtech Pvt. Ltd. Sub Lease Deed of:
Part 1 Vide Book No-1, Vol No-13251, Page No-299 to 450, Registration / Document No-11798, Sub Registrar Sadar, Gautambudh Nagar, (UP) on 22-05-2013, Part 2 Vide Book No-1, Vol No-14222, Page No-85 to 134, Registration / Document No-24479, Sub Registrar Sadar, Gautambudh Nagar, (UP) on 05-10-2013, Part 3 Vide Book No-1, Vol No-14828, Page No-227 to 282, Registration / Document No-781, Sub Registrar Sadar, Gautambudh Nagar, (UP) on 09-01-2014, Part 4 Vide Book No-1 6236, Page No-189 to 242, Registration / Document No-20325, Sub Registrar Sadar, Gautambudh Nagar, (UP) on 27-06-2014, Part 5 Vide Book No-1 Vol No- 16526, Page No-107 to 162, Registration / Document No-25183, Sub Registrar Sadar, Gautambudh Nagar, (UP) on 31-07-2014,
Project Approval No-16th Parkview, PLG/(BP)-29/4072/2017/27 Dated 15-11-2017, 2nd & 32nd Parkview: YEA/PLG/(BP)-62/19003/2016 Dated 31-03-2017, 3rd & 6th Parkview: YEA/PLG/(BP)-62/54470 Dated 10-04-2018, Gaurs Runway Suites: YEA/PLG/(BP)-96/79424 Dated 07-02-2019
Map Sanctioned of Gaurs Yamuna City Township Project vide letter Ref. No. YEA/PLANNING/80-62/19003/2016 Dated: 31/03/2017 by Yamuna Expressway Industrial Development Authority.
All images, perspective, specifications, features, figures, are only indicative and not a legal offering. All project related sanctions any other statutory compliance can be seen in person at our office.
1 sq. mtr = 10.764 sq. ft., 1 acre=4047 sq. mtr. (approx.)

13th/16th FLOOR PLAN (12A01-12A28)

DETAIL OF FLOORS				
AS PER BROCHURE*	AS PER SANCTION*	AS PER RERA **		
3RD FLOOR	3RD FLOOR	GROUND		
4TH TO 14TH FLOOR	4TH TO 14TH FLOOR	1ST TO 11TH FLOOR		
15TH FLOOR	15TH FLOOR	12TH FLOOR		
16TH FLOOR	16TH FLOOR	13TH FLOOR		



YAMUNA EXPRESSWAY

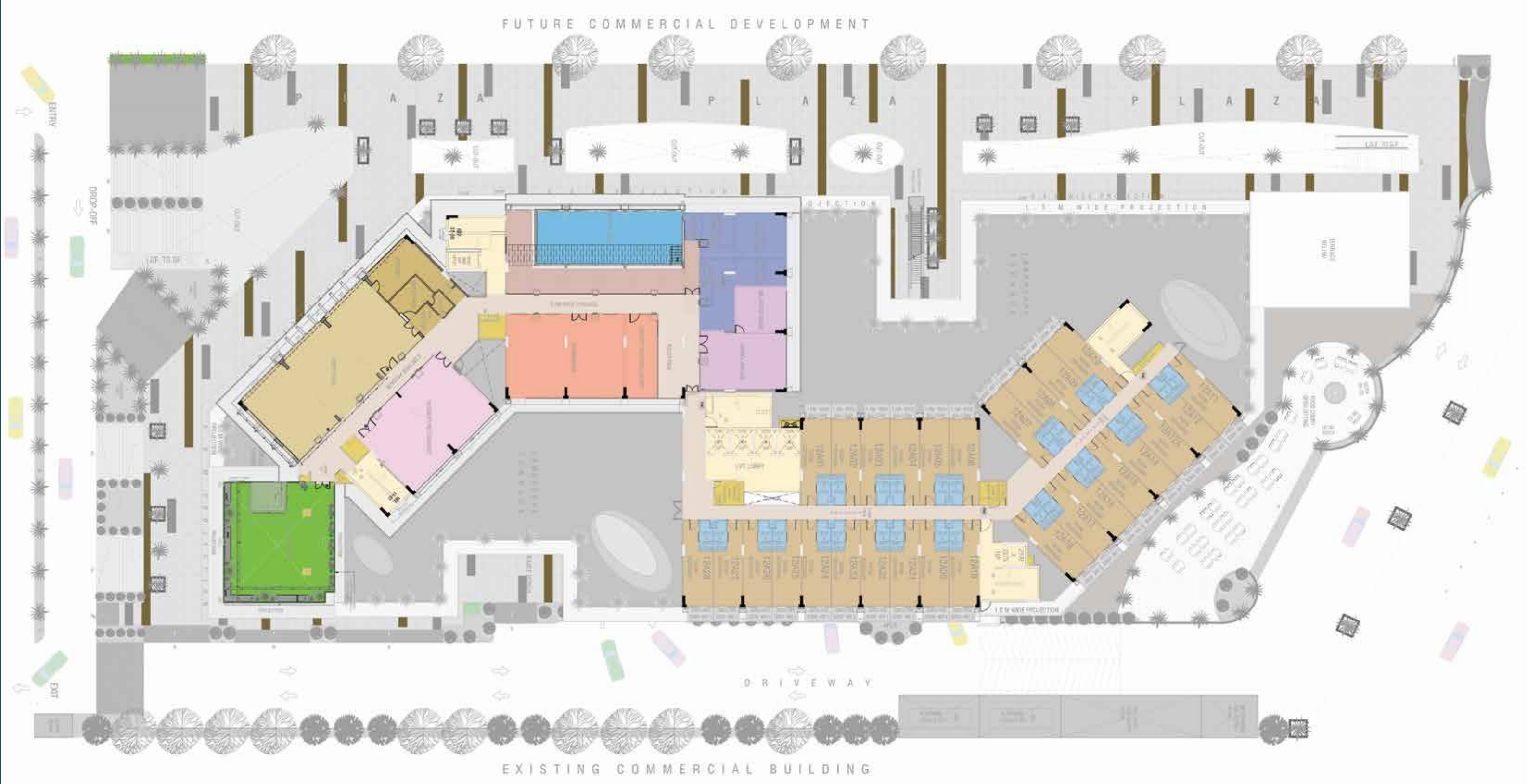

UNIT PLAN
ONE (1) BEDROOM

TOTAL SUPER AREA
42.73 SQ. MTR.
(460 SQ. FT.)



CARPET AREA	26.95 sq.mtr. (290.08 sq.ft)
EXTERNAL WALL AREA	1.33 sq.mtr. (14.32 sq.ft)
BALCONY AREA	4.12 sq.mtr. (44.35 sq.ft)
TOTAL COVERED AREA	32.40 sq.mtr. (348.75 sq.ft)
AVG. CIRCULATION AREA PER UNIT	8.38 sq. mtr. (90.25 sq.ft)
AVG. SERVICE AREA PER UNIT	1.95 sq. mtr. (21.00 sq.ft)
NET SUPER AREA	42.73 SQ. MTR. (460 SQ. FT.)

Disclaimer:
Total Area: The total area loading of other constructed areas including the constructed common areas overt the carpet area which is duly mentioned in the lay out plan of the unit.
Carpet Area: The Carpet area means the net usable floor area of a unit, excluding the area covered by the external walls, areas under services shafts, exclusive balcony or verandah area and exclusive open terrace area, but includes the area covered by the internal partition walls of the apartment.
1 Sqm=10.764 sq. ft., 304.8mm= 1'-0"
All Specification, designs, layout, images, conditions are only indicative and some of these can be changed at the discretion of the builder, these are purely conceptual and constitute no legal offerings.
•The colour and design of the tiles can be changed without any prior notice.
•Variation in the colour and size of vitrified tiles/granite may occur.
•Variation in colour in mica may occur.
•Area in all categories of apartments may vary up to ±3% without any change in cost.
•However, in case the variation is beyond ±3% charges are applicable.

SPECIFICATIONS OF COMMERCIAL STUDIO APARTMENTS

FLOORING	Vitrified tiles (130x800 mm) Flooring. Make-SARA, SOLE, SPEL, KAJARIA OR EQUIVALENT.
	Ceramic tiles (300x600mm) in balcony area . Make-SARA, SOLE, SPEL, ANMAL RANGE, KAJARIA OR EQUIVALENT.

WALL & CEILING FINISH	POP Finished Wall with OBD
	Ceiling with OBD. Make-BERGER, NEROLAC, SHALIMAR.

PANTRY	Dry Pantry Platform with Sink on Granite Counter Top, Make-PANTHER, LOTUS OR EQUIVALENT.
	600 mm DADO above the Working Top only with Granite.
	Woodwork Below the Working Top (non modular type)

TOILET	Ceramic Tiles (400x800 mm) on Floor. Make-SARA, SOLE, SPEL, ANMAL RANGE, KAJARIA OR EQUIVALENT.
	Ceramic Tiles (400x800mm) on Wall upto Door Height. Make-SARA, SOLE, SPEL, ANMAL RANGE, KAJARIA OR EQUIVALENT.
	White sanitary ware with wall mounted E.W.C Make-HINDWARE, PARRYWARE, JOHNSON OR EQUIVALENT.
	C.P Fittings Make-BLISS, PANTHER, JAGUAR OR EQUIVALENT.

DOORS & WINDOWS	Outer Door and Windows Aluminium Powder Coated/UPVC.
	Internal Door Frame (2250 mm) Made of Marandi or Equivalent Wood with Laminated Door Shutter Make-DURIAN, RAMA PLY OR EQUIVALENT.
	Main Entry Door Frame (2250mm) Made of Marandi or Equivalent Wood with Laminated Door Shutter Make-DURIAN RAMA PLY OR EQUIVALENT.
	Good Guality Hardware Fittings.

ELECTRICAL	Copper Wire in PVC Conduit with MCB Supported Circuits and Adequate Power and Light Points in Wall and Ceiling.
	MCB Make - LEGRAND, L&T, HAVELLS OR EQUIVALENT.
	Copper Wire Make - TYCON, HI AGE, CORUS OR EQUIVALENT.
	Switch & Sockets Make - ANCHOR, HONEYWELL OR EQUIVALENT.

TELEPHONE POINT	Intercom with Telephone Instrument.
-----------------	-------------------------------------

NOTES

- The colour and design of tiles can be changed without any prior notice.
- Variation in the colour and size of the vitrified tiles/granite may occur.
- Variation in colour in mica can occur.
- Area in all categories of apartments can vary upto +- 3%without any change in cost.
- However, in case the variation is beyond +- 3%, pro rata charges are applicable.

SPECIFICATIONS OF PROJECT



DETAILS OF GAURS RUNWAY SUITES

TOTAL NO. OF SUITES	828 Units
NO. OF FLOORS	3rd Floor (Suites & Landscape terrace). 4th- 14th Floor (Suites). 15th Floor (Suites & services). 16th Floor (Suites, Club, Infinity Pool & Landscape Party Terrace).



NO. OF UNITS PER FLOOR

3TH FLOOR	62 Suites (G-01 to G62) & Landscape Terrace of 1347 sq. mtr. (14500 sq.ft.) Appx.
4TH FLOOR-14TH FLOOR	62 Suites each Floor (101-162), (1101-1162)
15TH FLOOR	56 Suites (1201-1262) & Pool Service Area.
16TH FLOOR	28 Suites (12A01-12A28), GYM, SPA, Infinity Pool, Billiards Room, Cards Room, Library, Restaurant, Sports Room, Landscape Party Terrace, Banquets, Kitchen etc.



VITAL PROJECT RELATED INFORMATION

AIR CONDITIONING FLOOR TO FLOOR HEIGHT	Provision of Split AC in Suites. 3150 mm for Suites.
--	---



LIFTS AND ESCALATORS

SEPARATE LIFTS	4 Nos. Passenger Lift & 2 Service Lift for Suite / Club
SPECIFICATION OF LIFTS	SS Finish from Inside and Outside



LOBBY AND COMMON AREAS

FLOORING	Granite Flooring / Vitrified Tile Flooring
CEILING	Exposed RCC with running Services
PAINTING	OBD Paints and Exposed Services.
RAILING	M.S Railing with S.S Hand Rails.
WALLS	Plastered Walls with Tile, Dado upto 4'-0" with Paint Above



ELECTRICITY	Common Area and Corridor Lighting
FIRE FIGHTING	As Per Fire NOC
STAIRCASE LIGHTING	Granite / Tile Flooring Tube Light / Ceiling Mounted LED Light Fixture



BASEMENT AREA

ROAD AND PARKING LIGHTING	VDF Trimix Concrete Flooring / Pavers Tube Light / Ceiling Mounted LED Light Fixture
COMMON PARKING RAMP	As Per Drawings
FIRE FIGHTING	Trimix Concrete Flooring As Per Fire NOC



LANDSCAPING

HARD LANDSCAPE	Tiles / Trimix Concrete / Pavers / Kerb Stone / Chequered Tiles.
SOFT LANDSCAPE	Natural Grass / Artifical Grass Pad / Shrubs / Plants / Trees.
LIGHTING	As Per Design



ESS AND DG

DG SET	As per Load Requirement
TRANSFORMER	Dual meter with Electric Point Cable in each unit.



STP

CAPACITY (IN BASEMENT / LGF) As Per Requirement

DETAILS OF FLOOR GAURS RUNWAY SUITES														
AS PER RERA	13th Floor	12th Floor	11th Floor	10th Floor	9th Floor	8th Floor	7th Floor	6th Floor	5th Floor	4th Floor	3rd Floor	2nd Floor	1st Floor	Ground Floor
AS PER BROCHURE/ SANCTION	16th Floor	15th Floor	14th Floor	12 A Floor	12th Floor	11th Floor	10th Floor	9th Floor	8th Floor	7th Floor	6th Floor	5th Floor	4th Floor	3rd Floor



GAURS INTERNATIONAL SCHOOL

तमसो मा ज्योतिर्गमय।
@

GAUR YAMUNA CITY, YAMUNA EXPRESSWAY

THE RIVER OF KNOWLEDGE FLOWS AGAIN OPERATIONAL 3RD SCHOOL AT YAMUNA EXPRESSWAY

After the success of two branches of Gaurs International School at Gaur City with 4000+ students, we bring the premier educational institute to Gaur Yamuna City. Equipped with world-class facilities amidst top notch infrastructure and an international curriculum, Gaurs International School believes in nurturing your child in every aspect.

GIS HIGHLIGHTS

- AC Classrooms
- Best Teacher Student Ratio
- Smart Classrooms With Projectors
- Amphitheatre
- Music, Art & Dance Room
- Medical Room
- RFID Enabled ID Cards
- CBSE Based Curriculum
- Cricket Pitch
- Football
- Volley Ball
- GPS Enabled Buses



ACTUAL IMAGE

ARTIST'S IMPRESSION

ADMISSIONS NOW OPEN FOR SESSION 2024-2025

NURSERY TO 9TH STANDARD

www.gaursinternationalschool.com

Jai Shri Krishna



GAUR
YAMUNA
CITY

YAMUNA EXPRESSWAY

is blessed with India's tallest statue of
Lord Shri Krishna standing majestically
at 108 feet height atop a grand Temple
(Under development)



Artist's Impression



Scan for video



Disclaimer:

All images including stock images, colours, pictures and accessories are indicative and used for illustrative purposes only. For the actual project details, please refer to the specifications mentioned in the subsequent pages of this brochure.

SUCCESS FOUNDED ON TRUST



Ever since its inception in the year 1995, Gaurs has been revered as an icon of excellence in the world of real estate. With a burgeoning list of residential projects that encompass high end apartments to highly affordable accommodations occupied by thousands of happy families, Gaurs' stress on customer's trust has become the winning mantra.

The pointed, unnerving focus on creating a better tomorrow has been the driving force at Gaurs. It is our foresight, eye for perfect locations and excellence in execution that has earned us a much-deserved success throughout our long journey. And armed with the confidence and verve to enrich lives, one can safely say that the future belongs to Gaurs.



**REALTY+ CONCLAVE AND
EXCELLENCE AWARDS - NORTH 2024**
BEST SELLING
PROJECT OF THE YEAR
- **GAUR NYC RESIDENCES**



**REALTY+ CONCLAVE AND
EXCELLENCE AWARDS - NORTH 2024**
THEMED PROJECT
OF THE YEAR
- **GAUR NYC RESIDENCES**



**REALTY+ EXCELLENCE
AWARDS NORTH 2023**
ULTRA LUXURY LIFESTYLE
PROJECT OF THE YEAR
- **THE ISLANDS BY GAURS**



**REALTY+ EXCELLENCE
AWARDS NORTH 2023**
EXCELLENCE IN
DELIVERY
- **GAUR WORLD SMARTSTREET**



**REALTY+ EXCELLENCE
AWARDS NORTH 2022**
LUXURY PROJECT
OF THE YEAR
- **THE ISLANDS BY GAURS**



**MAPIC INDIA SHOPPING CENTER
AWARDS 2022**
BEST MALL FOR LEISURE AND
ENTERTAINMENT - DELHI NCR
- **GAUR CITY MALL**



**SMART CITY EMPOWERING INDIA
AWARDS 2020**
BEST SMART CITY
DEVELOPER OF THE YEAR
- **GAURSONS INDIA**



**PMAY EMPOWERING INDIA
AWARDS 2019**
THE MOST WELL PLANNED UPCOMING
PROJECT IN EWS CATEGORY
- **GAURS SIDDHARTHAM**



**CNBC AWAAZ REAL ESTATE
AWARDS 2018-19**
BEST RESIDENTIAL PROJECT
AFFORDABLE SEGMENT - NORTH ZONE
- **GAUR CITY-2**



**TIMES BUSINESS
AWARDS 2019**
BEST REAL ESTATE
DEVELOPER OF THE YEAR
- **GAURSONS INDIA**



**CNBC AWAAZ REAL ESTATE
AWARDS 2017-18**
BEST RESIDENTIAL PROJECT
AFFORDABLE SEGMENT - NATIONAL
- **GAUR CASCADES**



**CNBC AWAAZ REAL ESTATE
AWARDS 2017-18**
BEST RESIDENTIAL PROJECT
AFFORDABLE SEGMENT - NORTH INDIA
- **GAUR CASCADES**



**NDTV PROPERTY
AWARDS 2016-17**
BUDGET APARTMENT PROJECT OF
THE YEAR (2017) TIER 1 CITIES
- **GAUR CASCADES**



**NDTV PROPERTY
AWARDS 2016-17**
BEST TOWNSHIP
PROJECT
- **GAUR CITY**



**CNBC AWAAZ REAL ESTATE
AWARDS 2016-17**
BEST TOWNSHIP
PROJECT
- **GAUR CITY**

THE HALLMARKS TO OUR CREDIT



ONGOING RERA REGISTERED PROJECTS

Gaur Mulberry Mansions, Gr. Noida (West)
UPRERAPRJ7057, UPRERAPRJ4897
KrishnVilas (3rd Parkview)
Gaur Yamuna City **UPRERAPRJ16103**
Gaur Siddhartham, Siddharth Vihar,
Ghaziabad **UPRERAPRJ3935**
Victorian Villas (6th Parkview)
Gaur Yamuna City **UPRERAPRJ15838**
16th Parkview Phase-II,
Gaur Yamuna City **UPRERAPRJ6801**
7th Avenue, Phase-II, Gaur City,
Gr. Noida (West) **UPRERAPRJ6695**

14th Avenue Phase-II, Gaur City-2,
Gr. Noida (West) **UPRERAPRJ6742**
Gaur Runway Suites,
Gaur Yamuna City **UPRERAPRJ351477**
Gaur City Center Ph-II,
Gr. Noida (West) **UPRERAPRJ4780**
Aerocity Yamuna, Gaur Yamuna City
UPRERAPRJ342117
Gaur World SmartStreet,
(Formerly known as Gaur World Street)
Gr. Noida (W) **UPRERAPRJ674297**

7th Parkview, Gaur Yamuna City
UPRERAPRJ16087
Gaur Lakeshore Villas (1st-A Parkview),
Gaur Yamuna City **UPRERAPRJ574384**
Gaur Waterfront Plots, (1st-B Parkview),
Gaur Yamuna City **UPRERAPRJ235739**
The Islands by Gaurs, Greater Noida
UPRERAPRJ734569
Gaur Aero Mall & Passport Studios by
Gaurs, Ghaziabad: **UPRERAPRJ663149**
Gaur Aero Heights, Ghaziabad
UPRERAPRJ941355



DELIVERED COMMERCIAL PROJECTS

Gaur Plaza, Shalimar Garden, Ghaziabad
Gaur Residency-Gravity, Chander Nagar, Ghaziabad
Gaur Galaxy-Gravity, Vaishali, Ghaziabad
Gaur Square Govindpuram, Ghaziabad
Gaur Green City-Gravity, Indirapuram, Ghaziabad
Gaur Homes-Gravity, Govindpuram, Ghaziabad
Gaur Heights-Gravity, Vaishali, Ghaziabad
Gaur Ganga-Gravity, Vaishali, Ghaziabad
Gaur Ganga-I-Gravity, Vaishali, Ghaziabad
Gaur Ganga-II-Gravity, Vaishali, Ghaziabad

Gaur Green Vista-Gravity, Indirapuram, Ghaziabad
Gaur Gracious-Gravity, Moradabad
Gaur Global Village-Gravity, NH-24, Ghaziabad
Gaur Grandeur-Gravity, Sector-119, Noida
Gaur Valerio-Gravity, Indirapuram, Ghaziabad
Gaur Cascades-Hi-Street, NH-58, Raj Nagar Extn.
Gaur Biz Park, Indirapuram, Ghaziabad
Gaur Gravity, Indirapuram, Ghaziabad
Gaur City Plaza, Gaur City, Greater Noida West
Gaur City Galleria, Gaur City, Greater Noida West

Gaur City Arcade, Gaur City, Greater Noida West
GYC Galleria, Gaur Yamuna City, Yamuna
Expressway
Gaur Atulyam-Gravity, Gr. Noida
Gaur Saundaryam High-Street, Greater Noida
West
Gaurs Sportswood Arcade, Sec-79, Noida
Gaur City Center Phase-I, Gr. Noida (W)
14th Avenue High Street, Gr. Noida (W)



DELIVERED RESIDENTIAL PROJECTS

Gaur Residency, Chander Nagar
Gaur Galaxy, Vaishali
Gaur Heights, Vaishali
Gaur Ganga, Vaishali
Gaur Ganga 1, Vaishali
Gaur Ganga 2, Vaishali
Gaur Green City, Indirapuram
Gaur Green Avenue, Indirapuram
Gaur Green Vista, Indirapuram
Gaur Valerio, Indirapuram
Gaur Homes, Govindpuram

Gaur Homes Elegante, Govindpuram
Gaur Grandeur, Noida
Gaur Global Village, Crossings Republik
Gaur Gracious, Moradabad
Gaur Cascades, Raj Nagar Extn. Ghaziabad
Gaur Saundaryam, Gr. Noida (West)
1st Avenue, Gaur City
4th Avenue, Gaur City
5th Avenue, Gaur City
6th Avenue, Gaur City
10th Avenue, Gaur City-2

11th Avenue, Gaur City-2
12th Avenue, Gaur City-2
16th Avenue, Gaur City-2
Gaur Sportswood, Sector-79, Noida
Gaur Atulyam, Gr. Noida
14th Avenue, Ph-1, Gaur City-2
7th Avenue, Ph-1, Gaur City
2nd Parkview, Gaur Yamuna City
16th Parkview Phase-1, Gaur Yamuna City
32nd Parkview, Gaur Yamuna City
Gaurs Platinum Towers, Sector-79, Noida



EDUCATION

Gaurs International School
Gaur City-2, Greater Noida (West)
Junior Wing, Gaur City-2, Gr. Noida (West)
Gaur Yamuna City, Yamuna Expressway
Gaurs Siddhartham, Siddharth Vihar, Ghaziabad



DELIVERED RETAIL PROJECTS

Gaur City Mall, Greater Noida (W)
Gaur Central Mall, RDC, Raj Nagar, Ghaziabad



HOTELS

The Gaurs Sarovar Premiere, Gaur City,
Gr. Noida West

30+
YEARS OF UNFALTERING
COMMITMENT

70+
SUCCESSFULLY
DELIVERED PROJECTS

45000+
POSSESSIONS
GIVEN (2014-2023)

75000+
DELIVERED
UNITS

100000+
HAPPY
CUSTOMERS

6500000+
SQUARE METER
AREA DEVELOPED



Rera No.:
UPRERAPRJ351477
<https://up-rera.in/projects>



Scan for
Location Map

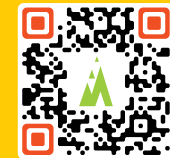

Map not to scale

FOR SALES
ENQUIRY CALL:



SITE OFFICE:

SEC-19, YAMUNA EXPRESSWAY, DIST. GAUTAM BUDDH NAGAR (U.P.)

CORPORATE OFFICE:

GAUR BIZ PARK, PLOT NO-1, ABHAY KHAND II, INDIRAPURAM GHAZIABAD - 201014

GAURSONS REALTECH PVT LTD MASTER COMMERCIAL-1 RECEIVABLE ACCOUNT

PROJECT COLLECTION ACCOUNT NO.: 001472500000042 | YES BANK LTD | IFSC CODE: YESB00000014

Plot No. 38, Block H 1 A, Sector 6, 3, Noida, UTTAR PRADESH | BRANCH MAIL ID: vaibhav.agarwal@yesbank.in

www.gaursonsindia.com



www.gaursonsindia.com

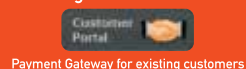

Payment Gateway for existing customers



@gaursonsindia

LOAN AVAILABLE
FROM:



CONSTRUCTION
FINANCE PARTNER



AFTER SALES **CUSTOMER CARE 1800 309 3052**

REAL ESTATE | RETAIL | EDUCATION | HOTELS | NBFC | CONTRACTING | SPORTS | ENERGY